

UCLA CAMPUS GUIDE

2023 NORTH AMERICAN SUMMER MEETING

JUNE 22 - 25, 2023

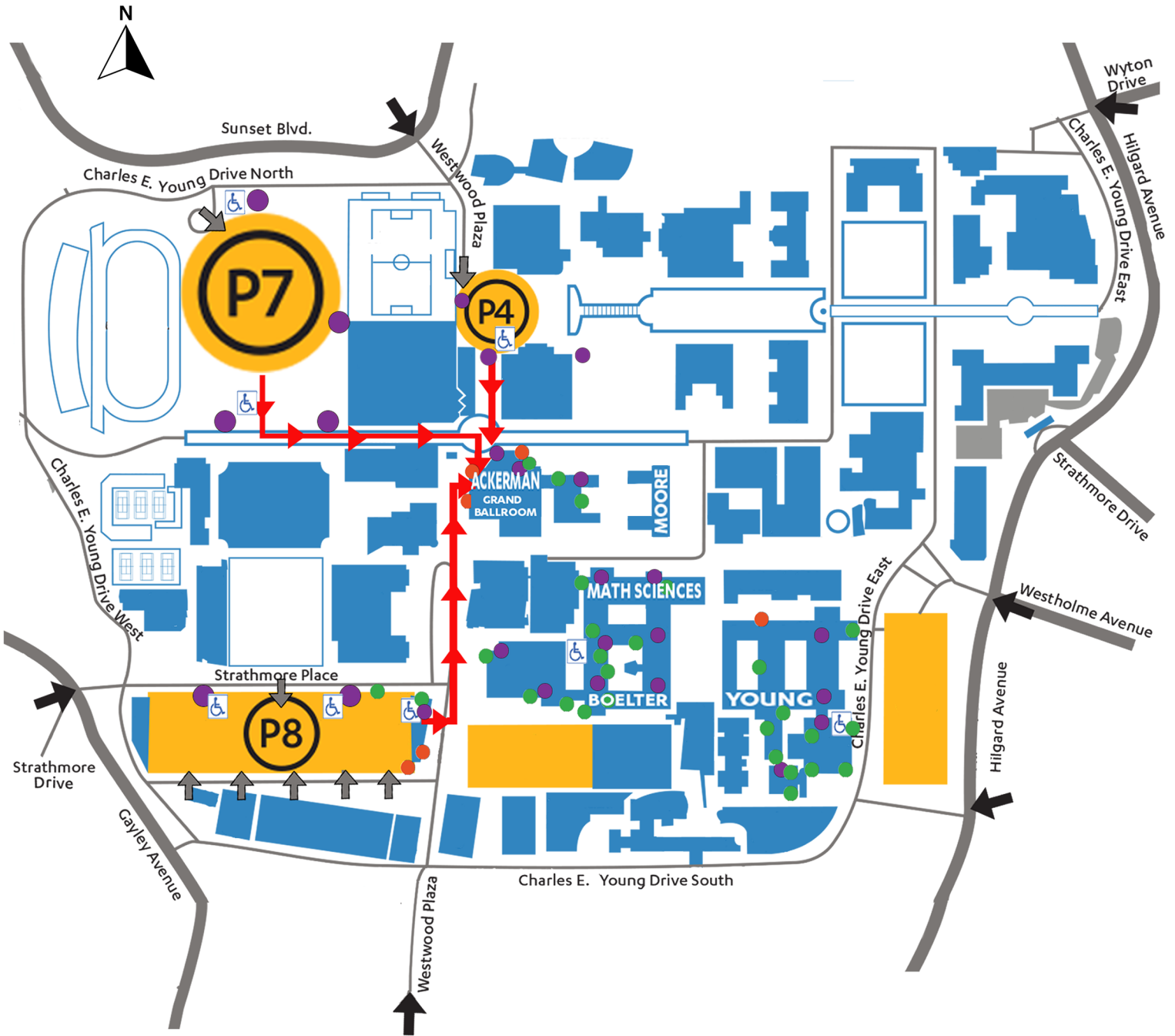



LOS ANGELES, UNITED STATES



UCLA

-  PARKING STRUCTURES
-  PARKING LOTS
-  CAMPUS BUILDINGS
-  CAMPUS ENTRANCES
-  PATHS TO ACKERMAN
-  PARKING LOT ENTRANCES

ACCESSIBLE AREAS

-  Parking*
-  Elevator
-  Accessible Entrance
-  Power Assisted Entrance

* One icon may represent multiple individual parking spaces. Spaces may also be present on multiple levels, or below ground level in subterranean parking structures. As with any map, temporary conditions (such as construction or special events) may obstruct access to individual parking locations or paths.

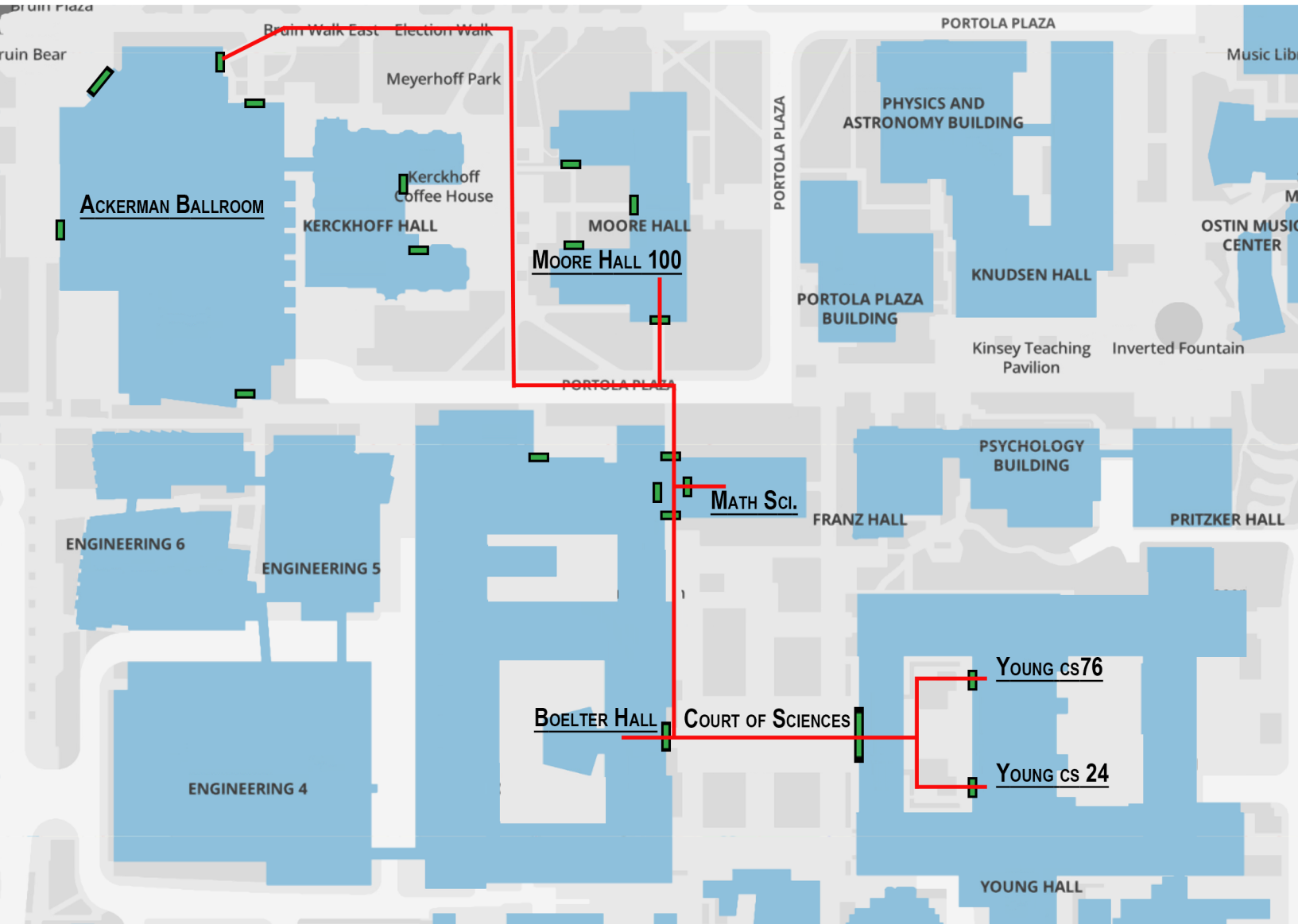

NOTICE: GUESTS WHO FOLLOW THE DIRECTIONS AND ENTER FROM THE COURT OF SCIENCES WILL ENTER ON THE **FIFTH** FLOOR.



GREEN RECTANGLES INDICATE ENTRANCES INTO BUILDINGS OR RELEVANT CLASSROOMS.

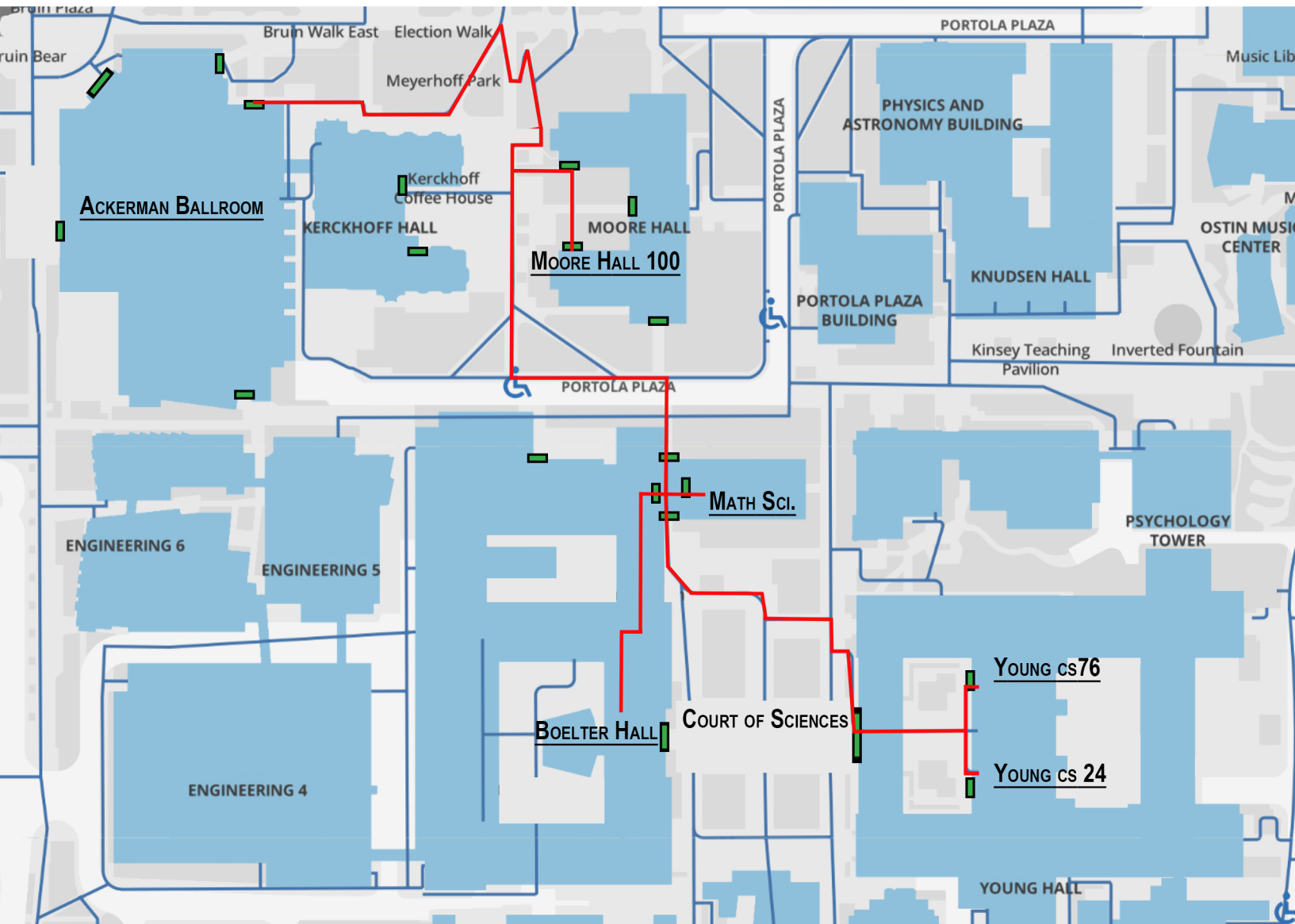

NOTICE: GUESTS WHO FOLLOW THE DIRECTIONS AND ENTER FROM THE COURT OF SCIENCES WILL ENTER ON THE **FIFTH** FLOOR.

 GREEN RECTANGLES INDICATE ENTRANCES INTO BUILDINGS OR RELEVANT CLASSROOMS.

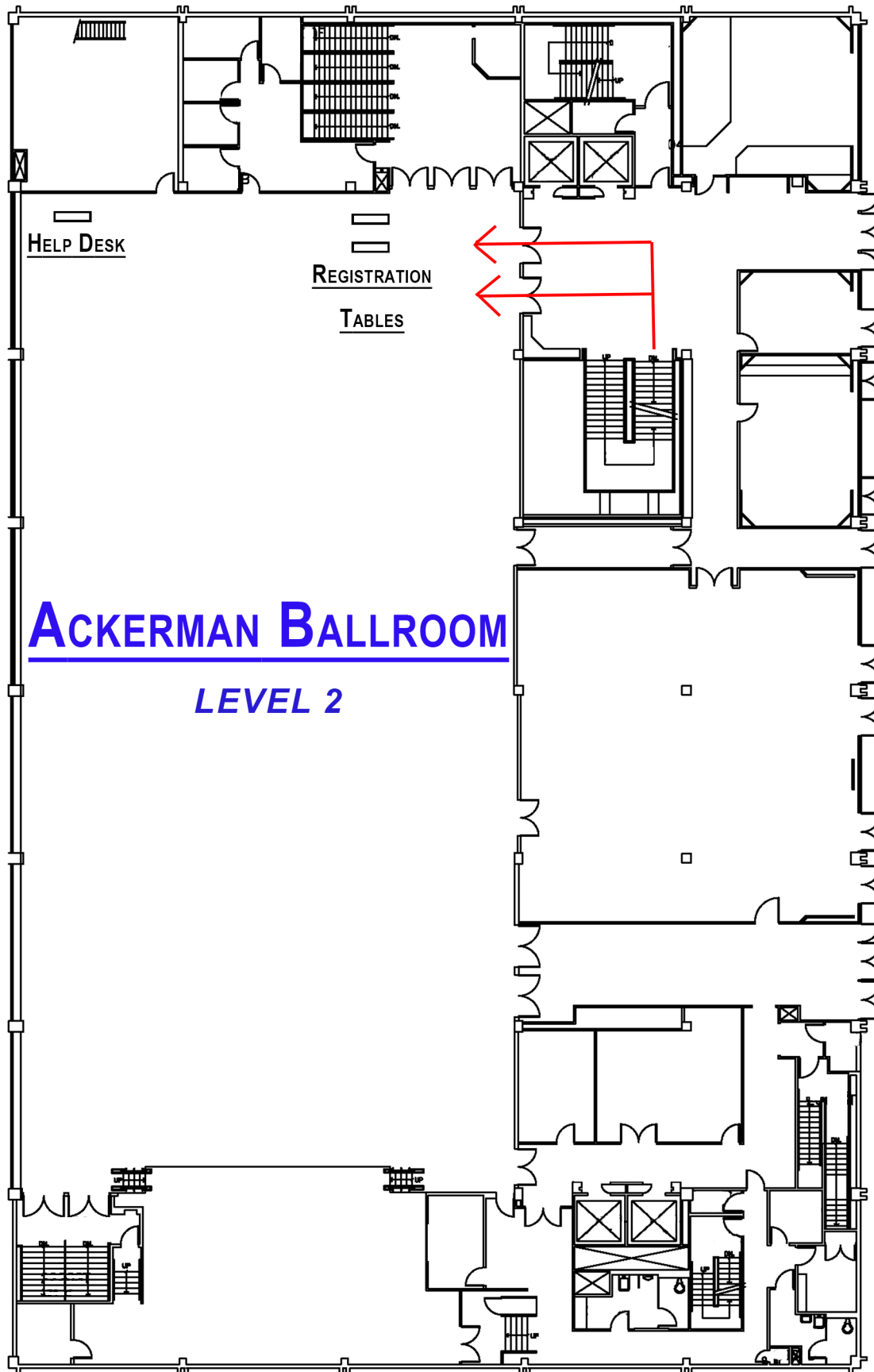



To ACKERMAN BALLROOM

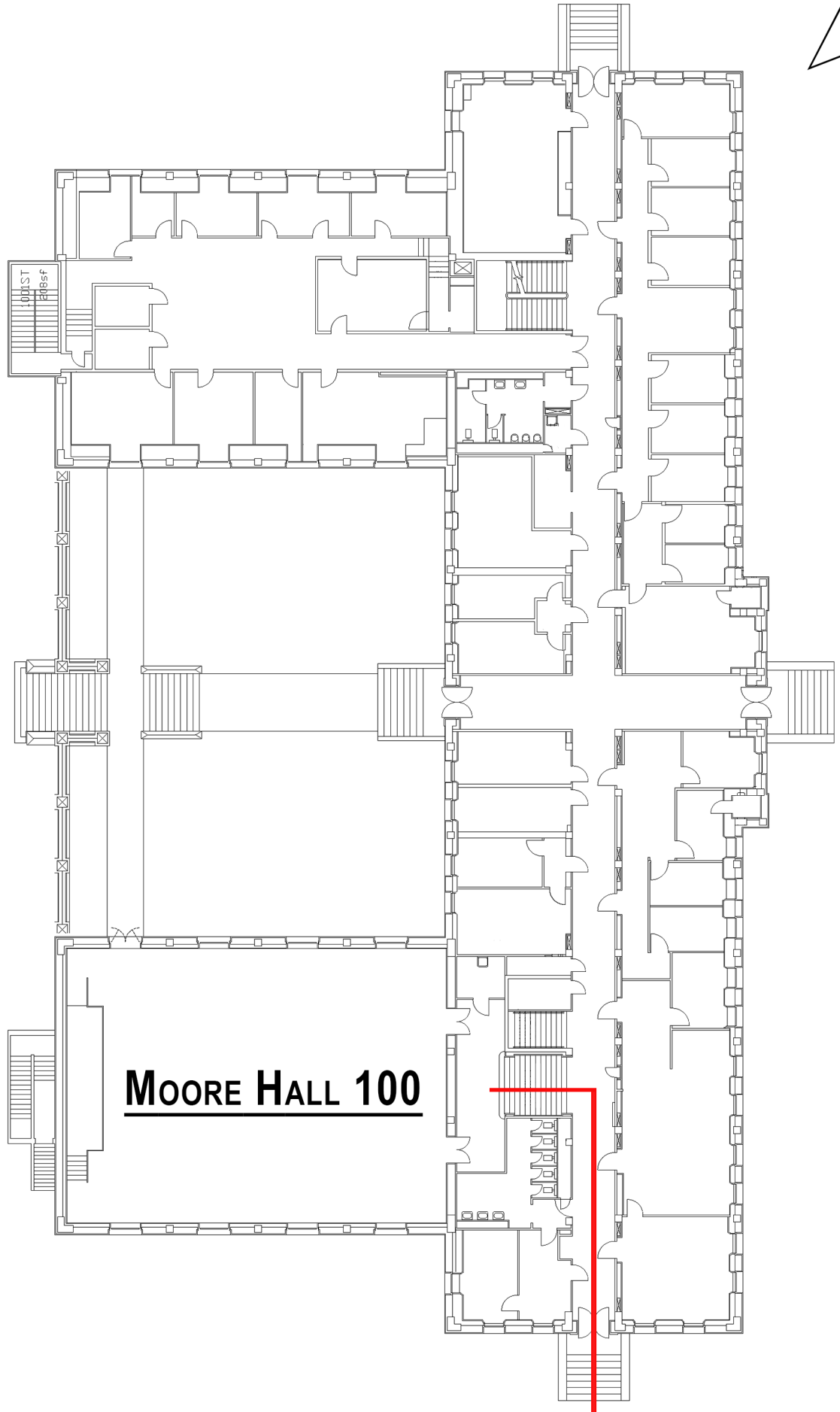

MOORE HALL 100

To ACKERMAN BALLROOM

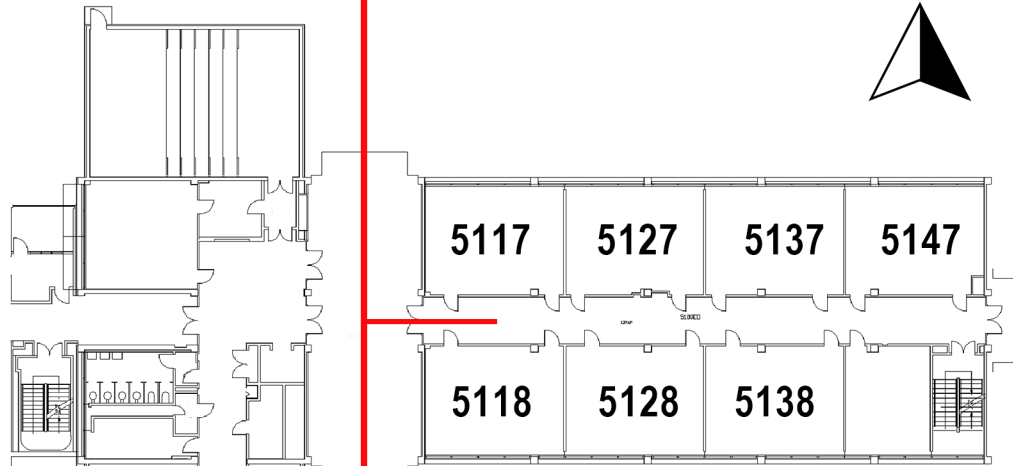

MATHEMATICAL SCIENCES

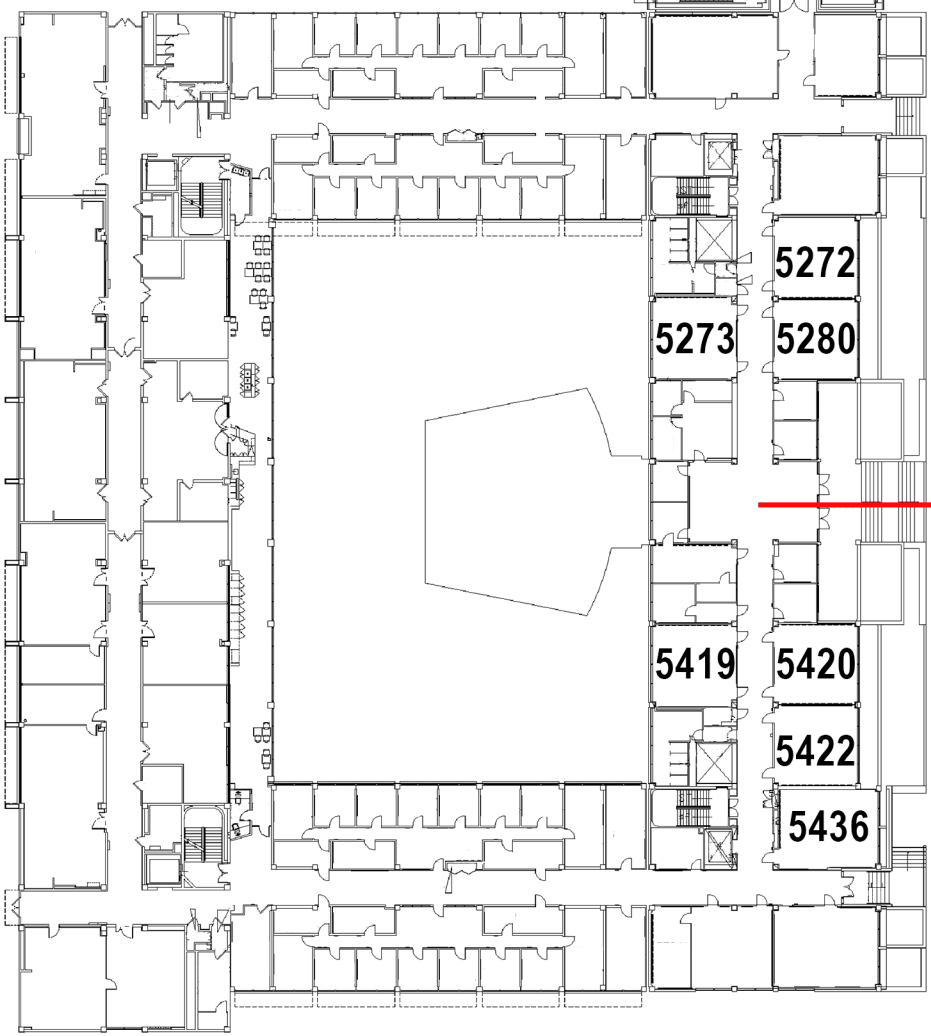

BOELTER HALL

To YOUNG CS 24/76



BOELTER HALL

WG YOUNG

CS76

CS24

